

The BIDET SHOP[®]

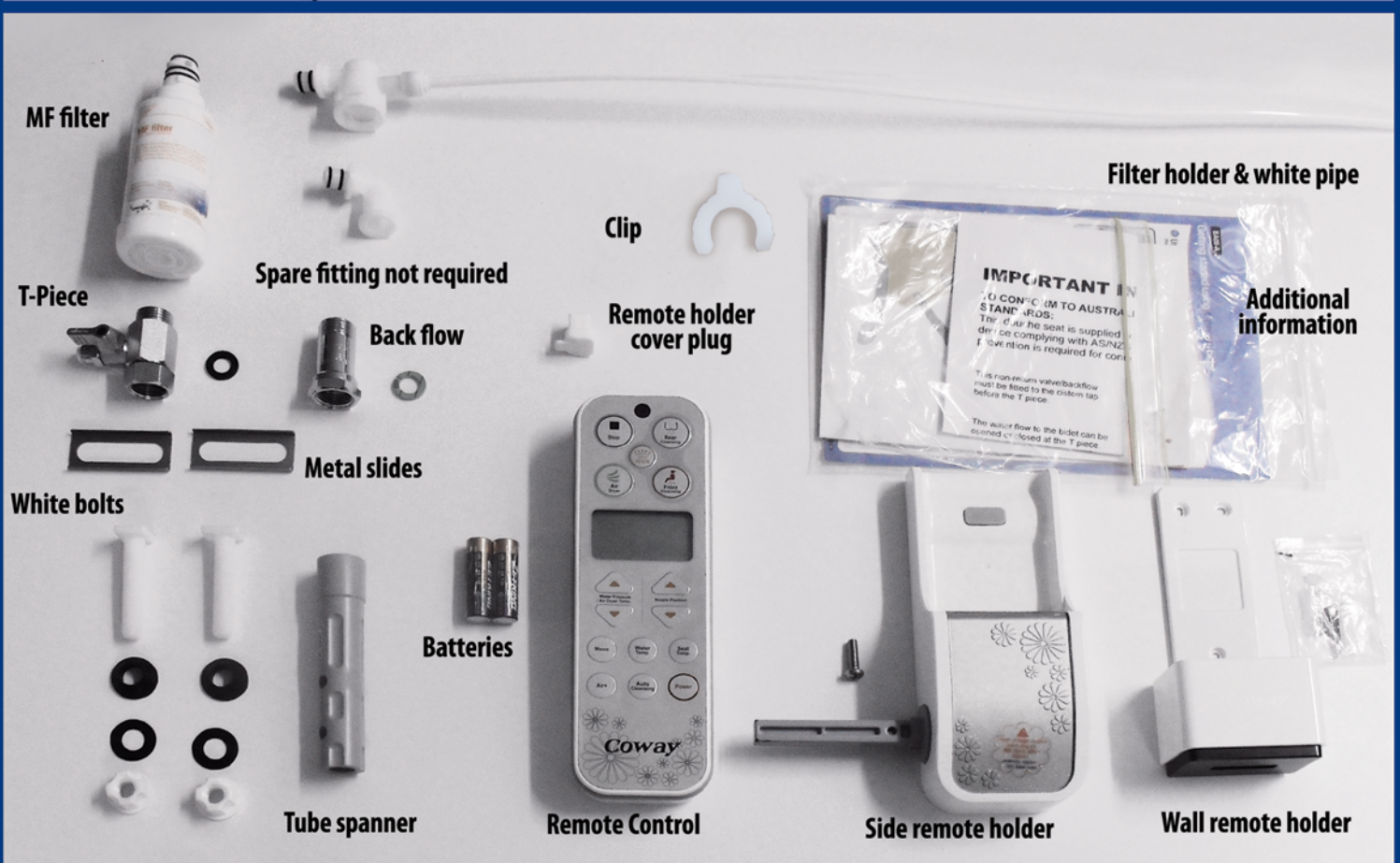

First, place out all parts.



1

First, turn off water supply.
Remove existing seat and existing hose to cistern.



2

Install Backflow valve (Dualcheck) with
green washer on water supply.

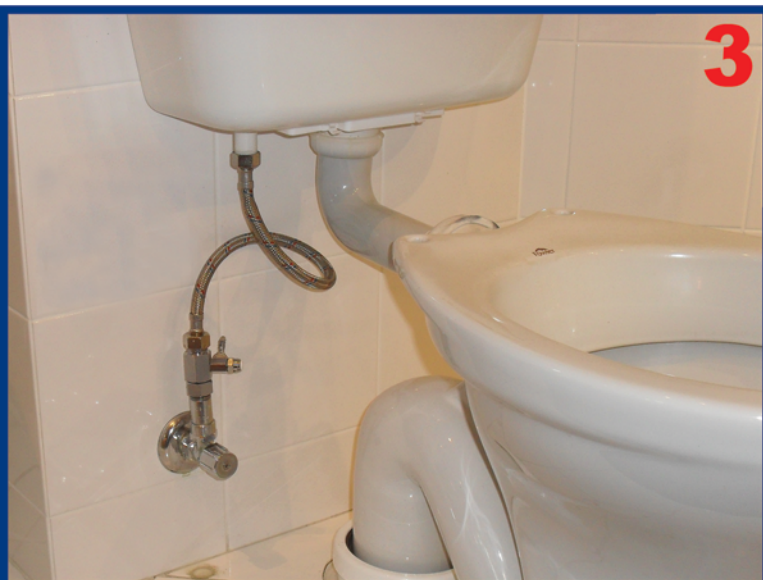

3

Then install T-Piece and flex hose to cistern.



4

Push white pipe into T-Piece. This is a John Guest
fitting and needs to be inserted securely.

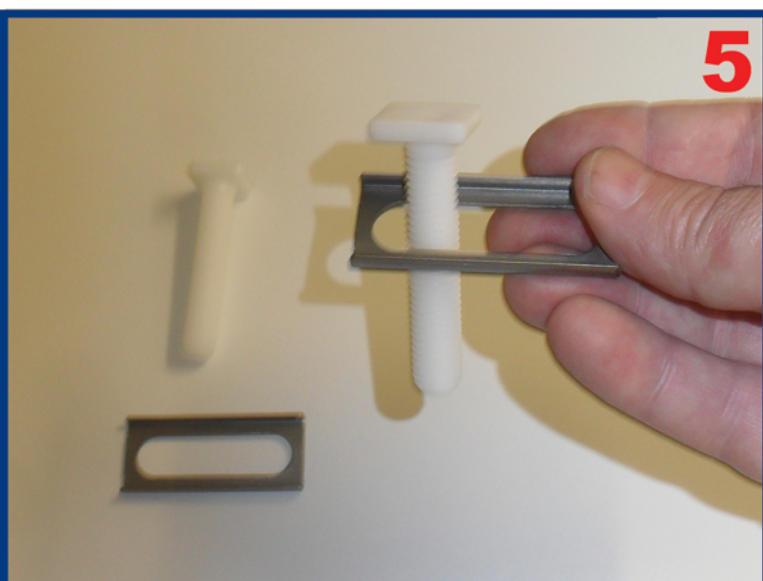

5

Put white bolts into metal slides.

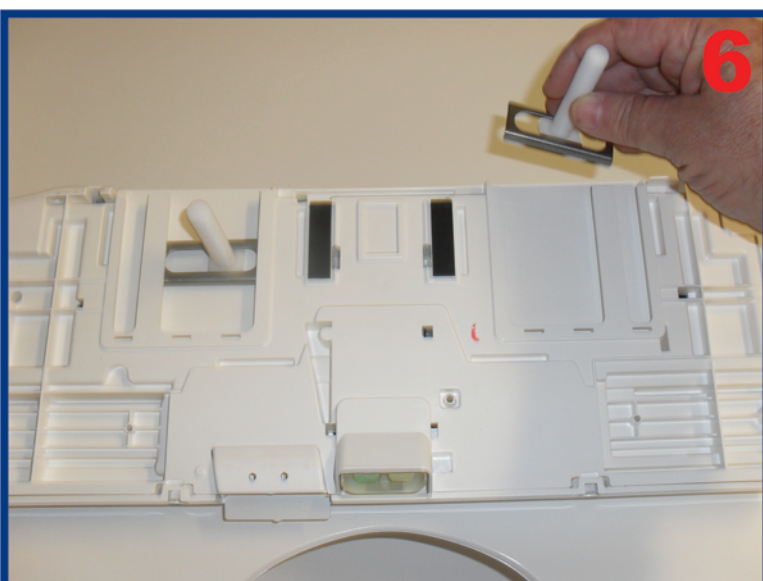

6

Insert metal slides into wide tracks under the bidet.



7

Place bidet onto toilet and set in position, now install and tighten nuts with supplied tube spanner.



8

Insert white pipe into filter holder then push holder into the back of the bidet.

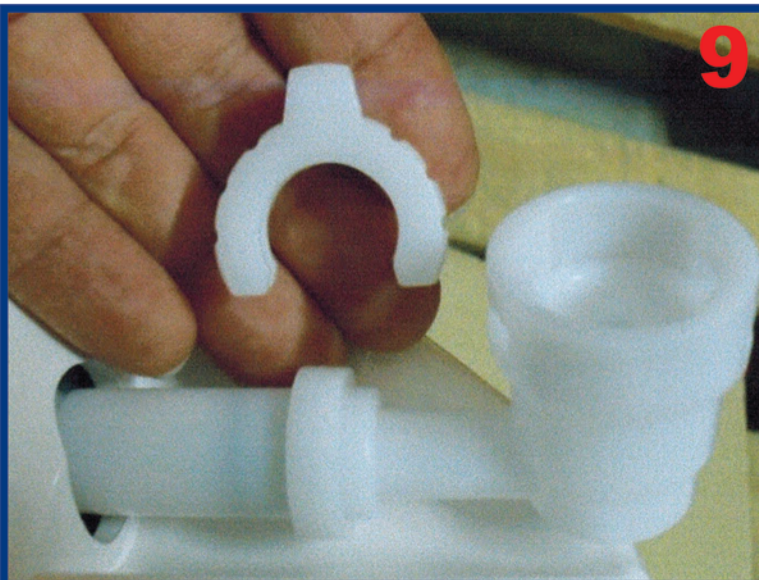

9

Simply push clip onto raised area where filter holder and bidet are joined



10

Insert MF filter into filter holder and turn to the right to secure.



11

Place remote control holder with remote into either side of bidet. The bar can be swayed by undoing the screw.



12

Remove remote from remote holder.

13



Place remote control holder with remote into either side of bidet. The bar can be swayed by undoing the screw.

14



Remove remote from remote holder.

15



Unscrew battery cover and place in batteries.

16

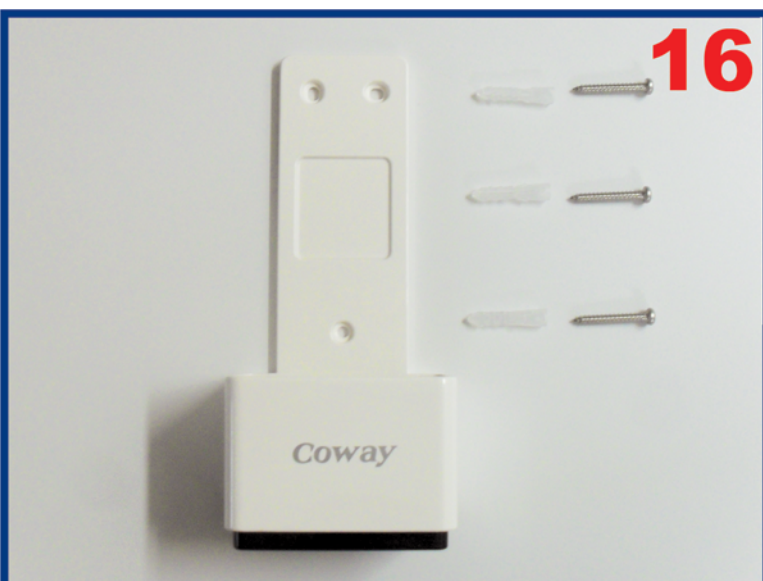

If the remote control is required on the wall, the wall holder can be screwed in.

Installation & Backflow Requirements

This device must be installed in accordance with AS/NZS 3500.1

Adjustments: Remote is pre-programmed but if adjustments are required please see user manual

Trouble Shooting: (see user manual for more)

Q: Water is coming out of the fitting where the white pipe pushes in.

A: You did not push in the pipe hard enough.

Q: The nozzle extends but water will not come out.

A: Check the lever on the T-Piece is in a horizontal position.

Q: The bidet does not work. (remote has batteries)

A: A hand must be on the seat (bottom-right) to activate seat sensor / bidet

Spare Parts: If spare parts (shown in user guide) are needed please contact our help desk

Filters: Manufacturer recommends water filters be replaced every 4-6 months

Please call the helpdesk on 1800 243 387 or 07 5591 7744 for any queries

Model name	BA08-AR/AE
Power rating	220 V - 240 V~ 50 Hz, 60 Hz
Power consumption	850 W
Operating Water pressure	110 KPa - 680 KPa
Operating Temperature	0°C - 40°C



THIS DOUCHE SEAT IS SUPPLIED WITH A BACKFLOW PROTECTION DEVICE COMPLYING WITH AS/NZS 3500.1. NO FURTHER BACKFLOW PREVENTION IS REQUIRED FOR CONNECTION TO THE WATER SUPPLY.

WMTS-051:2016